

---

# Quick Guide

## spinit<sup>®</sup> CRP



# Quick Guide | How to perform a spinit® CRP test?



Adhesive flap

Blister

Sample well

1



- Remove disc from refrigerator and wait to reach room temperature;
- Press the start button on spinit® screen and follow on screen instructions;
- After scanning the barcode from the disposable cartridge, prepare the disc:



- Take the disc out of the pouch and lift the adhesive flap;
- Place the disc on a plain surface with label facing up;
- Press the reagent blister with your thumb;

- Massage finger and disinfect the area before puncture;
- Prick finger and wipe off the first drop of blood;
- Collect the 5 µL of blood with the appropriate capillary tube and allow blood to reach the indicator line;



NOT enough sample



Correct amount of sample

- Release the blood onto the disc and gently press the upper part of the capillary tube;
- After releasing the blood keep pressing the tube;
- After use, discard the tube appropriately;
- Seal the disc by removing flap protection and firmly seal it up from the centre towards the end;

2

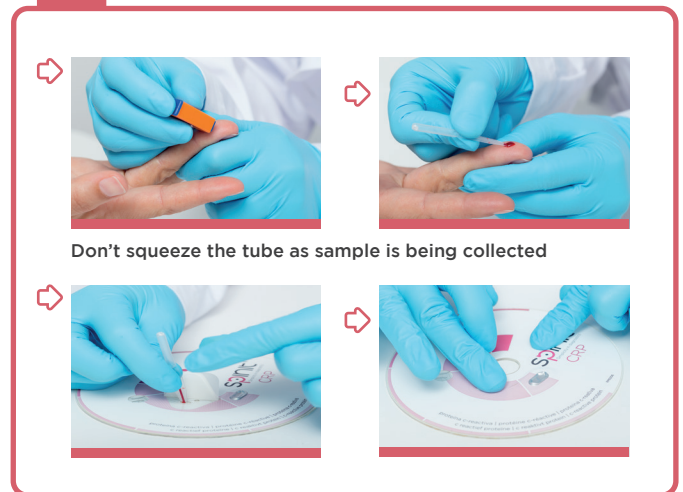

Don't squeeze the tube as sample is being collected



- Once you have the disc ready, click Next on the screen;
- Place the disc into the instrument and follow on screen instructions;
- Wait for the test result;
- Discard disc appropriately.

3

